**PB****Installation and Operating Instructions  
安 装 使 用 说 明**

Version 2022.1

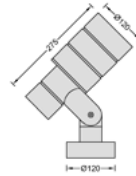

Wall luminaires / 侧壁灯

## 9 15x 04 xx PB S



### Important Information / 重要信息

- The installation and maintenance of the product can only use the original parts, and the installation and operation of the equipment shall be subject to national and international regulations.  
本产品安装和维护工作只能使用原厂配件，设备的安装和操作适用于国家和国际法规。
- DMK is not liable for any damages resulting from improper or unskilled conduct.  
DMK 不承担任何因不当或不熟练行为而造成的损害赔偿。
- Only qualified installation personnel are allowed to assemble and install products obtained from the DMK.  
只允许有安装资质的人员组装和安装从 DMK 获得的产品。
- The contents of this manual are subject to change without prior notice. Please refer to the material in kind.  
本说明书的内容如有变更，恕不另行通知。请以实物为准。
- If in doubt, please contact the supplier.  
如有疑问，请与供应商联系。

### Toolings / 工具

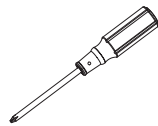

十字螺丝刀



3/4/8mm 内六角扳手

### Recommended Installation Procedure / 推荐安装过程

- Connect the power cable as shown below.  
按下图所示连接 220V 灯具电源线。



This step should be operated by professional personnel to avoid electric shock.  
此步骤需由专业人员操作，以免发生触电危险。

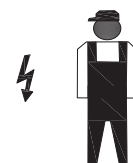
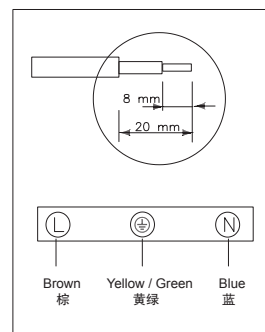

**Recommended Installation Procedure / 推荐安装过程**

2. Fix the mounting base to the working plane with 4-M5×30 inner hexagon screw. connect the fixture and mounting base with M4 × 12 hex socket screw, adjust to the appropriate direction and lock.  
将灯具底座用 4-M5×30 内六角螺钉与安装平面固定，灯体与安装底座采用 M4 × 12 内六角螺钉连接，调整至合适方向锁紧。

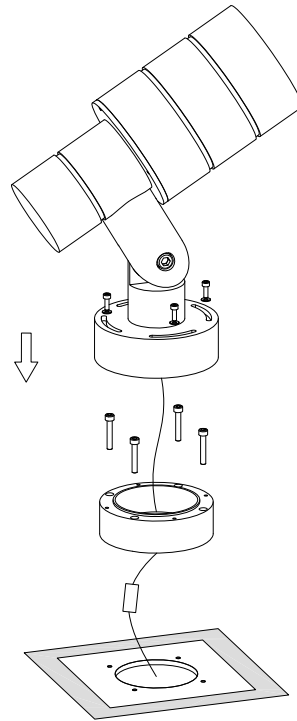

3. Adjust appropriate projection Angle and lock the M10 inner hexagon screw and M6 set screw.  
灯头仰角调整至合适角度，锁紧支臂连接处 M10 内六角螺钉，及 M6 紧定螺钉。

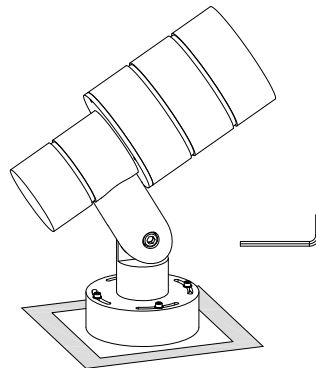

## 9 153 04 xx PB Sx



220~  
240V

Class I

Ra>80



CE

IP 65

IK

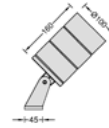

### Important Information / 重要信息

- The installation and maintenance of the product can only use the original parts, and the installation and operation of the equipment shall be subject to national and international regulations.  
本产品安装和维护工作只能使用原厂配件，设备的安装和操作适用于国家和国际法规。
- DMK is not liable for any damages resulting from improper or unskilled conduct.  
DMK 不承担任何因不当或不熟练行为而造成的损害赔偿。
- Only qualified installation personnel are allowed to assemble and install products obtained from the DMK.  
只允许有安装资质的人员组装和安装从 DMK 获得的产品。
- The contents of this manual are subject to change without prior notice. Please refer to the material in kind.  
本说明书的内容如有变更，恕不另行通知。请以实物为准。
- If in doubt, please contact the supplier.  
如有疑问，请与供应商联系。

### Toolings / 工具

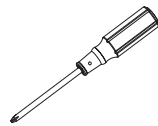

十字螺丝刀



5mm 内六角扳手



10mm 开口扳手

### Recommended Installation Procedure / 推荐安装过程

- Fix the mounting bracket with the installation plane by 2-M6 x 60 expansion bolts.  
将安装支架用 2-M6 x 60 膨胀螺栓与安装平面固定。
- Adjust appropriate projection Angle, and lock the M6 nut on the bracket.  
灯体调整至合适投射角度，锁紧支架上 M6 螺母。
- Fix the anti-drop chain to other positions.  
将防坠链固定到安装平面其他位置。

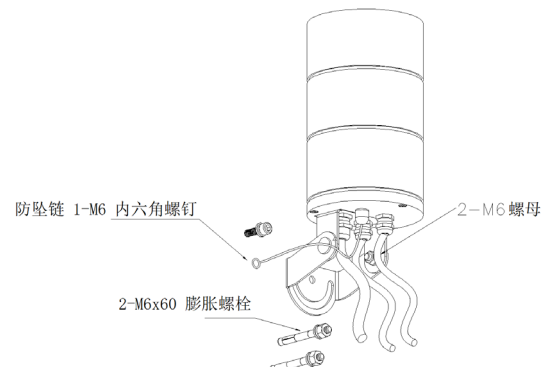

**Recommended Installation Procedure / 推荐安装过程**

4. Connect the power cable as shown below. (Note: This step should be operated by professional personnel.  
按下图所示连接 220V 灯具电源线。(注: 此步骤需由专业人员操作)

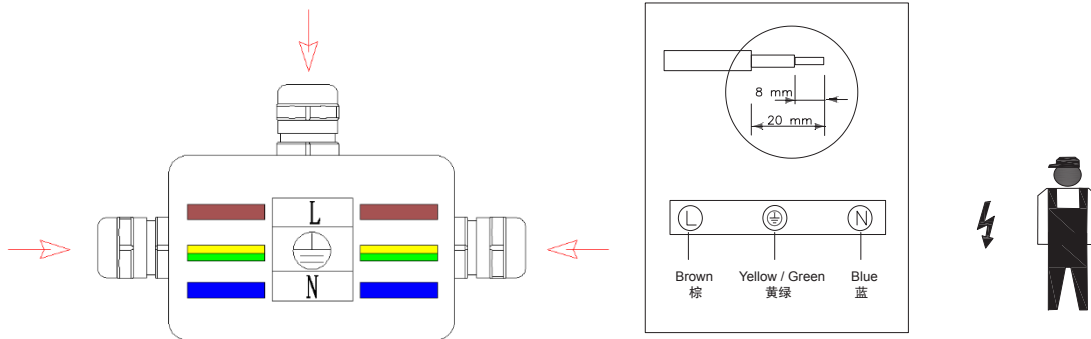

5. Connect the DMX signal control line as shown below (note: this step should be operated by professionals.  
按下图连接灯具 DMX 信号控制线 (注: 此步骤需由专业人员操作)

